

SUBMERSIBLE SEWAGE PUMPS

ACCESSORY

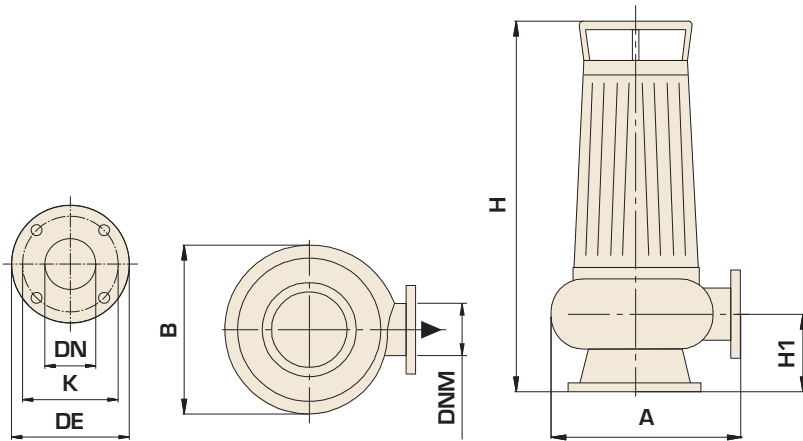

SQ

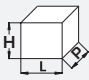

TYPE	DIMENSIONS mm					DIMENSIONS mm 			Weight Kg
	A	B	H	H1	Grain size inlet (mm)	P	L	H	
Three-phase									
SQ 42 - 3	310	270	580	125	Ø 60	400	320	770	77
SQ 50 - 4	310	270	600	125	Ø 60	400	320	770	79
SQ 65 - 5,5	330	280	670	130	Ø 70	450	370	980	119

APPLICATION

Thanks to their important features, SQ pumps are the ideal solution for the carriage of waters coming from cleaners, sewing systems, zootechnic farms, slaughter-houses, foundries and for irrigation in agricultural field.

Applicable in fishing industry, paper mills and in civil and industrial plants. The pumps adopt open single-blade impeller which allows free passage of suspended parts and high performance.

MATERIALS

- | | |
|--------------------|------------------|
| - Motor body | Cast iron |
| - Pump body | Cast iron |
| - Impeller | Cast iron |
| - Shaft with rotor | Stainless steel |
| - Mechanical seal | Ceramic/Graphite |

Tipo - Type	DIMENSIONI mm - DIMENSIONS mm					
	DN	DE	K	fori - holes		flange flanges
				n°	Ø	
SQ 42-3	80	190	150	4	18	3"
SQ 50-4	80	190	150	4	18	3"
SQ 65-5,5	100	210	170	4	18	4"

OPERATING CONDITIONS

- Liquid temperature up to 40°C
- Submersion depth max. 5 mt.
- Liquid PH from 4 to 10
- Continuous duty with completely submersed pump
- Liquid density 1,2 Kg/dm³

MOTOR

- Insulation Class F
- Protection IP 68
- Thermic protection

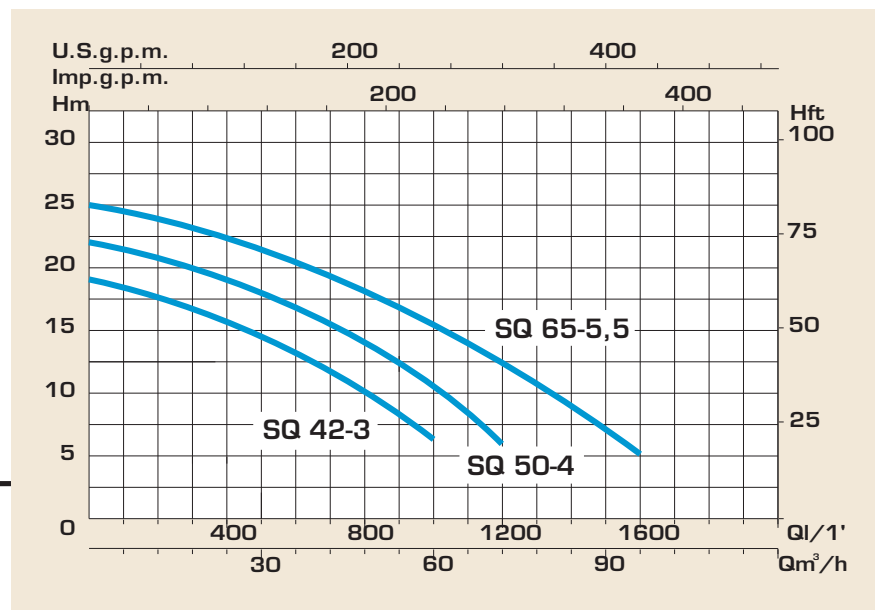

TYPE	NOMINAL POWER P2		INPUT POWER P1	AMPERE	Q = CAPACITY											
	HP	kW			kW	Total head in meters w.c.										
Three-phase				Three-phase	m³/h	6	12	18	24	36	48	60	72	84	96	
230/400V-50Hz				3 x 400V	lt/1'	100	200	300	400	600	800	1000	1200	1400	1600	
SQ 42 - 3	4	3	4	7	H (m)	18	17	16	15	13	10	6				
SQ 50 - 4	5,5	4	5,5	9,3		22	21	20	19	16	13	10	6			
SQ 65 - 5,5	7,5	5,5	7,5	12,3		25	24	23,5	23	21	18	15	12	8	5	